

Drawings

EJA510E, EJA530E Absolute and Gauge Pressure Transmitter

DPharp **EJA**[®]

SD 01C31F01-01EN

[Style: S1, S2]

Unit: mm (approx. inch)

• With Process connections code 7

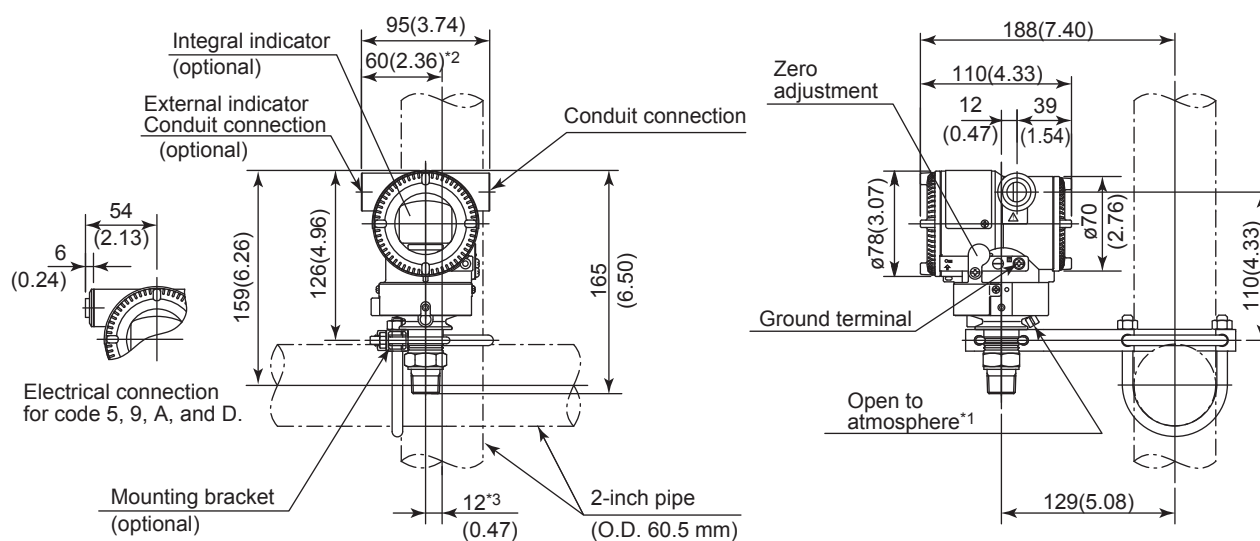

*1: Only for EJA530E whose measurement span code is A, B, or C.

*2: 58 mm (2.28 inch) for measurement span code D.

*3: 11 mm (0.43 inch) for measurement span code D.

*4: When electrical connection code 7 or C is selected, a blind plug is protruded up to 8 mm from the conduit connection.

• With Process connections code 4



• With Process connections code 8 and 9

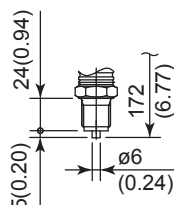

- **Terminal Configuration**

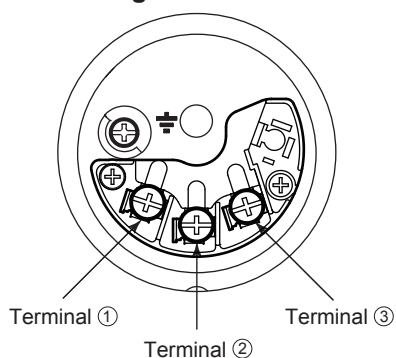

- **Terminal Wiring for 4 to 20 mA output, FOUNDATION Fieldbus and PROFIBUS PA communication types**

SUPPLY	+	①	Power supply and output terminals
	-	②	
CHECK	+	③	External indicator (ammeter) terminals*1*2
	-	②	
			Ground terminal

*1: When using an external indicator or check meter, the internal resistance must be 10 Ω or less.

*2: Not available for FOUNDATION Fieldbus and PROFIBUS PA communication types.

- **Terminal Wiring for 1 to 5 V output**

SUPPLY	+	①	Power supply terminals
	-	②	
VOUT	+	③	1 to 5 V DC with HART communication terminals
	-	②	
			Ground terminal

Three or four wire connection. For four wire connection, both supply and signal lines use SUPPLY - terminal.